

AUTOPLUS 505 separate gas hose

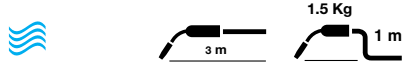

V peak	113	mm	1.0 - 1.2 1.6	X	550A CO ₂ 500A Mix
bar	2÷4 bar	l/min	1.6 l/min		

CODE	↔	IS
MB7960	3 m - 45°	EURO
MB7965	3 m - 0°	EURO



TORCH HEAD REPAIR KIT

MT0209

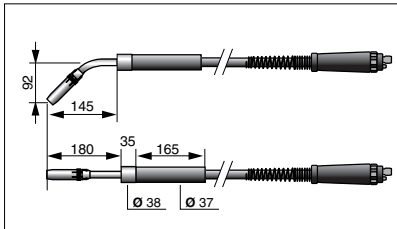
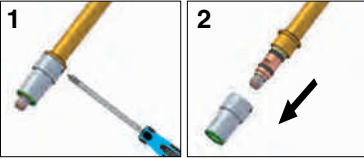

Il serraggio preciso fra la ghiera e il portagello garantisce un'ottima dispersione del calore

The precise tightening of the between the ring nut and the nozzle assures excellent heat dispersion

Die Ringmutter zum Befestigen der Düse garantiert eine langlebige Düsen-/Brennergehäuse-kupplung

Le serrage précis entre la bague et l'électrode garantit une optimale dispersion de la chaleur

La sujeción precisa entre la abrazadera y la tobera garantiza una excelente dispersión de calor

Nozul ve nozul sabitleyici arasındaki kusursuz sıkıştırma mükemmel ısı dağılımı sağlar

Плотная притирка сопла обеспечивает отличный отвод тепла

IT Raffreddamento del corpo torcia + portagello + punta guidafile

EN Cooling circuit for torch head + nozzle holder + contact tip

DE Brennerkörper + Gasdüsenträger + Stromdüsen Kühlung

FR Refroidissement du corps de torche + porte buse + tube contact

ES Refrigeración del cuerpo antorcha + porta tubo de contacto + tubo de contacto

TR Soğutma (Torç boynu + Nozul tutucu + Kontak meme)

RU Охлаждение головки горелки, держателя наконечника и контактного наконечника

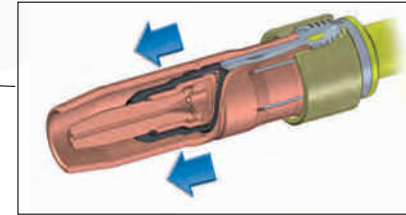

TRAFIMET STYLE



EN 60974-7



Better performances
and protection
for your torch

UTI000157

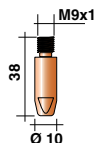
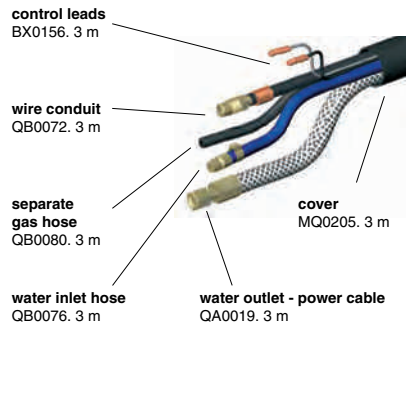

ME0345
Copper



ME0089 plastic **ME0589** ceramic

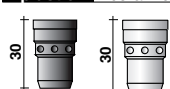

Ø	Cu for Al	CuCrZr
1,0		MD0250-80
1,2	MD0250-62	MD0250-82
1,4		MD0250-84
1,6	MD0250-66	MD0250-86
2,0	MD0250-70	MD0250-90
2,4	MD0250-74	MD0250-94

MC0346	MC0348	MC0345	MC0347
80	80	80	80
Ø 14	Ø 15	Ø 16	Ø 19

STANDARD

(REF.)

