

PLUS 505

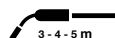

1.5 Kg



V_{peak}	113	Ø	1.0 - 1.2 1.6	X	550A CO ₂ 500A Mix
-------------------------	-----	----------	------------------	----------	----------------------------------

Pressure	2÷4 bar	Flow	1.6 l/min
-----------------	---------	-------------	-----------

CODE	↔	IS
MB7933	3 m	EURO
MB7934	4 m	EURO
MB7935	5 m	EURO

Special Trafimet Original spare parts



IT Il serraggio preciso fra la ghiera e il portaugello garantisce un'ottima dispersione del calore

The precise tightening of the between the ring nut and the nozzle assures excellent heat dispersion

Die Ringmutter zum Befestigen der Düse garantiert eine langlebige Düsen-/Brennergehäuse-Kupplung

Le serrage précis entre la bague et l'électrode garantit une optimale dispersion de la chaleur

La sujeción precisa entre la abrazadera y la tobera garantiza una excelente dispersión de calor

Nozul ve nozul sabitleyici arasındaki kusursuz sıkıştırma mükemmel ısı dağılımı sağlar

Плотная притирка сопла обеспечивает отличный отвод тепла

IT Raffreddamento del corpo torcia + portaugello + punta guidafile

EN Cooling circuit for torch head + nozzle holder + contact tip

DE Brennerkörper + Gasdüsenträger + Stromdüsen Kühlung

FR Refroidissement du corps de torche + porte buse + tube contact

ES Refrigeración del cuerpo antorcha + porta tubo de contacto + tubo de contacto

TR Soğutma (Torç boynu + Nozul tutucu + Kontak memesi)

RU Охлаждение головки горелки, держателя наконечника и контактного наконечника

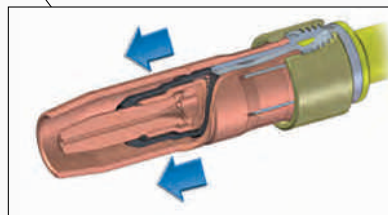

TRAFIMET STYLE

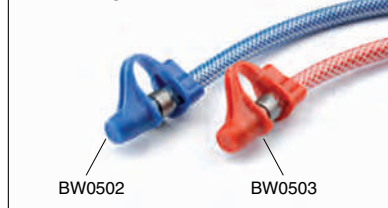

TORCH HEAD REPAIR KIT

MT0209

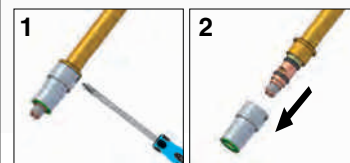

EURO



EN 60974-7



Better performances
and protection
for your torch



UTI000157

control leads
BX0156. 3 m
BX0157. 4 m
BX0158. 5 m

wire conduit
QB0072. 3 m
QB0073. 4 m
QB0074. 5 m

gas hose
QB0080. 3 m
QB0081. 4 m
QB0082. 5 m

water inlet hose
QB0076. 3 m
QB0077. 4 m
QB0078. 5 m

water outlet - power cable
QA0019. 3 m
QA0020. 4 m
QA0021. 5 m

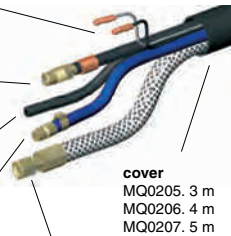

cover
MQ0205. 3 m
MQ0206. 4 m
MQ0207. 5 m

ME0345
Copper



ME0089
plastic



ME0589
ceramic

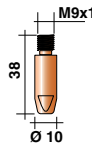

Ø	Cu for Al	CuCrZr
1,0		MD0250-80
1,2	MD0250-62	MD0250-82
1,4		MD0250-84
1,6	MD0250-66	MD0250-86
2,0	MD0250-70	MD0250-90
2,4	MD0250-74	MD0250-94

MC0346	MC0348	MC0345	MC0347

STANDARD

(REF.)

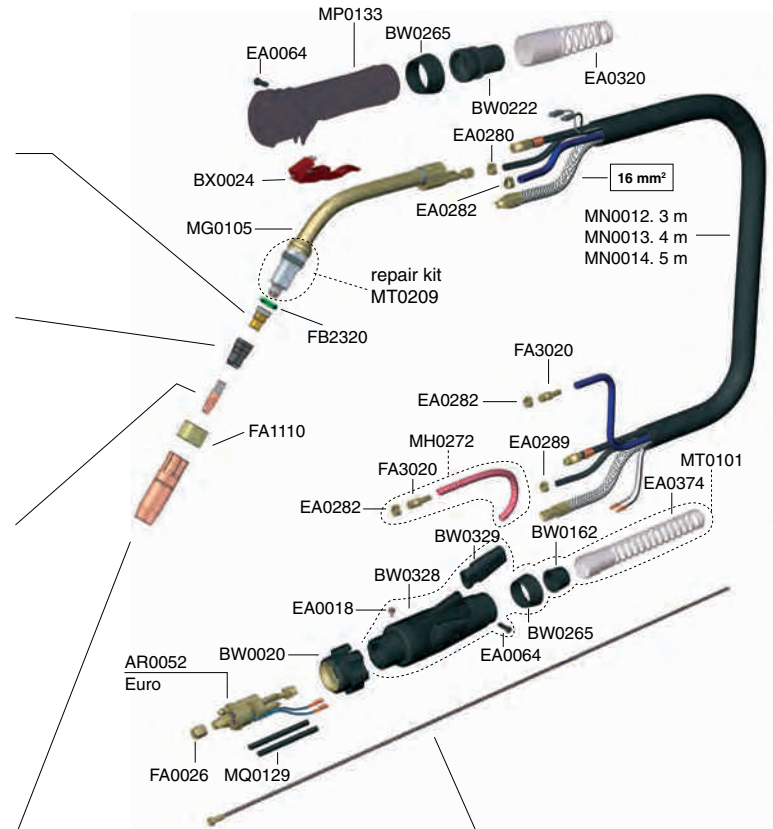

uncoated	
Wire 1,2 + 1,6	m Steel
	3 GM0530
	4 GM0531
	5 GM0532