

B 200



V_{peak}	113	Ø_{mm}	0.6 - 0.8 1.2 - 1.6	X	200A CO ₂ 150A Mix
				60%	

CODE	↔	
F16702.4	3,65 m / 12'	EURO - BD



EN 60974-7



ME0109 (4235)

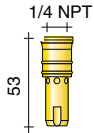

ME0110 (4335)

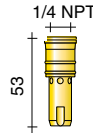

Ø	Cu
0,6	MD0214-06 (1597)
0,8	MD0214-08 (1588)
0,9	MD0214-09 (1589)
1,0	MD0214-10 (1596)
1,2	MD0214-12 (1590)
1,4	MD0214-14 (1598)
1,6	MD0214-16 (1591)
2,0	MD0214-20 (1592)
2,4	MD0214-24 (1593)
2,8	MD0214-28 (1594)
3,2	MD0214-32 (1595)



Ø	Cu
0,6	MD0215-06 (7497)
0,8	MD0215-08 (7488)
0,9	MD0215-09 (7489)
1,0	MD0215-10 (7496)
1,2	MD0215-12 (7490)
1,4	MD0215-14 (7498)
1,6	MD0215-16 (7491)
2,0	MD0215-20 (7492)
2,4	MD0215-24 (7493)
2,8	MD0215-28 (7494)

MC0415 (4392) **MC0416 (4394)** **MC0417 (4391)** **MC0418 (4393)**

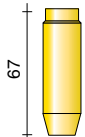

Ø 12,5



Ø 12,5

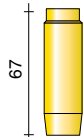

Ø 16



Ø 16

MC0419 (4295)

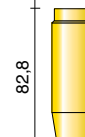

Ø 9,5

TIPS 4280 / 81 / 82 / ...

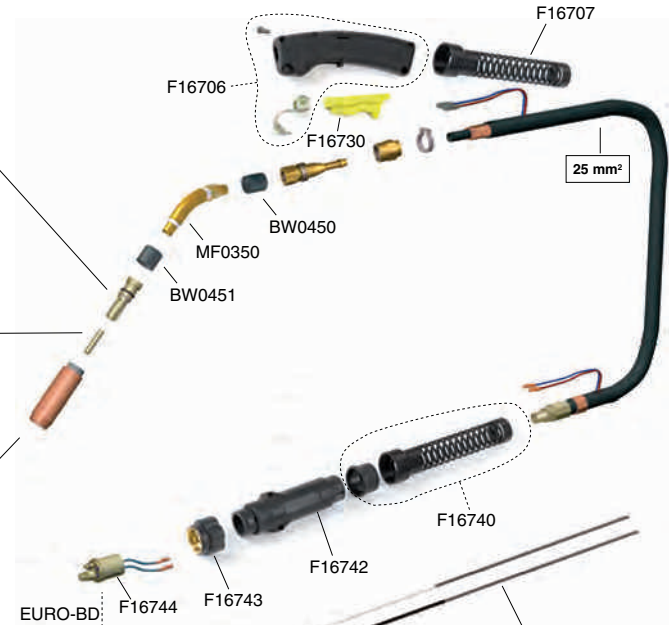

Wire 0,6 ÷ 0,8	
black color	
m	Steel
4,5	F16747.5

Wire 1,0 ÷ 1,6	
white color	
m	Steel
4,5	F16749.5

Wire 0,9 ÷ 1,2	
black color	
m	Steel
4,5	F16748.5

STANDARD

(REF.)