

## PRATIX MIG 15

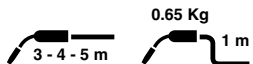

<b>V</b> peak	113	<b>Ø</b> mm	0.6 - 0.8 0.9 - 1.0	<b>X</b> 60%	180A CO <sub>2</sub> 150A Mix
------------------	-----	----------------	------------------------	-----------------	----------------------------------

CODE	↔	
MA0485	3 m	EURO
MA0486	4 m	EURO
MA0487	5 m	EURO



EURO



EN 60974-7





Ø mm	Ø in	Cu	Cu-Ni	Cu for Al	CuCrZr
0,6	.023	MD0008-06 (140.0008)	MD0008-36		
0,8	.030	<b>MD0008-08 (140.0059)</b>	MD0008-38	MD0008-58 (141.0002)	MD0008-78 (140.0062)
0,9	.035	MD0008-09 (140.0177)			
1,0	.040	MD0008-10 (140.0253)	MD0008-40	MD0008-60 (141.0007)	MD0008-80 (140.0256)
1,2	.045	MD0008-12 (140.0387)	MD0008-42	MD0008-62	MD0008-82

MC0017 (145.0123)	<b>MC0018 (145.0075)</b>	MC0266 (145.0143)	MC0019 (145.0041)	MC0020 (145.0168)
----------------------	------------------------------	----------------------	----------------------	----------------------

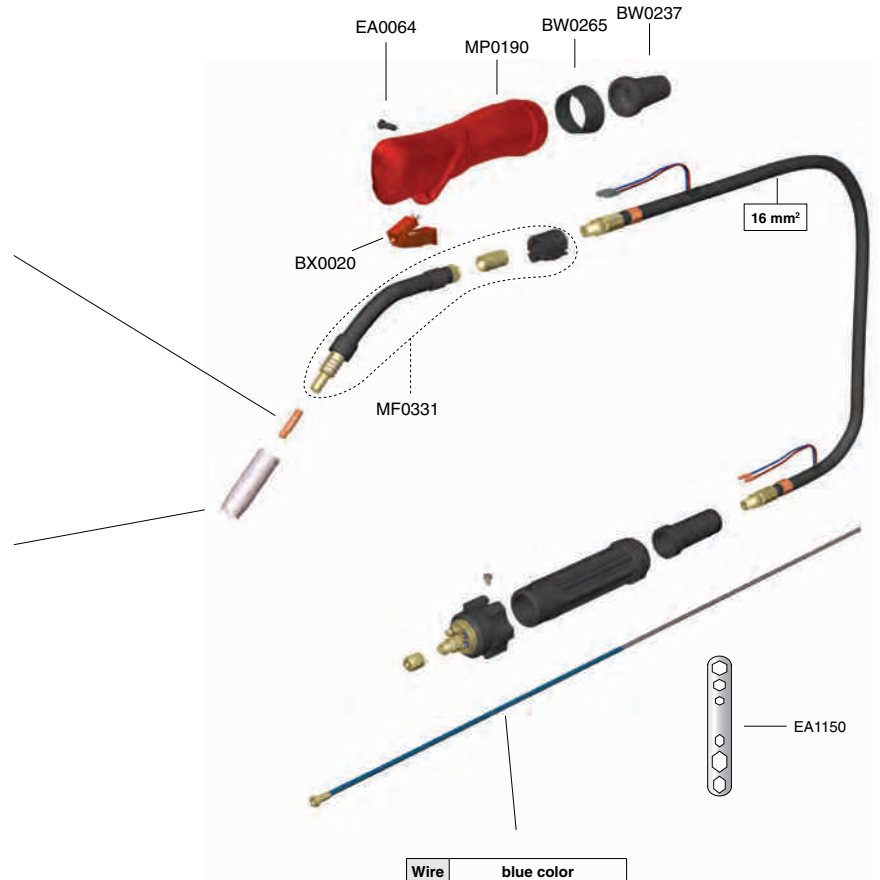
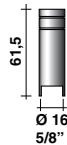
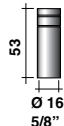
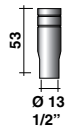
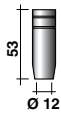
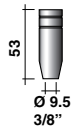

Wire	blue color	
		Steel
0.6 ± 0.09 .023" ± .0035"	3 m / 10'	<b>GM0500</b> (124.0011)
	4 m / 12'	<b>GM0501</b> (124.0012)
	5 m / 16,4'	<b>GM0502</b> (124.0015)

STANDARD