

TMAX 500



3 - 4,6 m
10' - 15'

1.4 Kg
3,2 lb

1 m
3,3'

V peak 113
mm 1.0 - 2.0 mm
.040" - 5/64"
X 60% 550A CO₂
500A Mix

CODE	↔	Ⓜ
MA6485	3 m / 10'	EURO - TW
MA6486	4 m / 12'	EURO - TW
MA6487	4,6 m / 15'	EURO - TW

MA6494T	3 m / 10'	TWECO®
MA6495T	4 m / 12'	TWECO®
MA6496T	4,6 m / 15'	TWECO®
MA6494M	3 m / 10'	MILLER®
MA6495M	4 m / 12'	MILLER®
MA6496M	4,6 m / 15'	MILLER®
MA6494L	3 m / 10'	LINCOLN®
MA6495L	4 m / 12'	LINCOLN®
MA6496L	4,6 m / 15'	LINCOLN®

CODE	↔	Ⓜ
MA6494	3 m / 10'	5/8-18 UNF
MA6495	4 m / 12'	5/8-18 UNF
MA6496	4,6 m / 15'	5/8-18 UNF

Liner included



CODE	KIT
AR0170	Tweco® 1/4 KIT
AR0172	Lincoln® KIT
AR0173	Miller® KIT

Kit to be assembled
by a qualified technician
[see page 291](#)



EURO - TW

TWECO®

MILLER®

LINCOLN®

5/8-18 UNF



EN 60974-7



ME0368
Copper

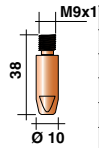
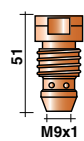

Ø mm	Ø in	Cu for Al	CuCrZr
0,8	.030		MD0250-78
0,9	.035		MD0250-79
1,0	.040		MD0250-80
1,2	.045	MD0250-62	MD0250-82
1,4	.052		MD0250-84
1,6	1/16	MD0250-66	MD0250-86
2,0	5/64		MD0250-90
2,4	3/32		MD0250-94

MC0298	MC0011	MC0012	MC0013
--------	--------	---------------	--------

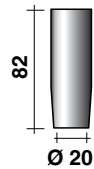
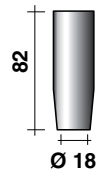
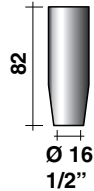
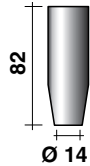

STANDARD

(REF.)

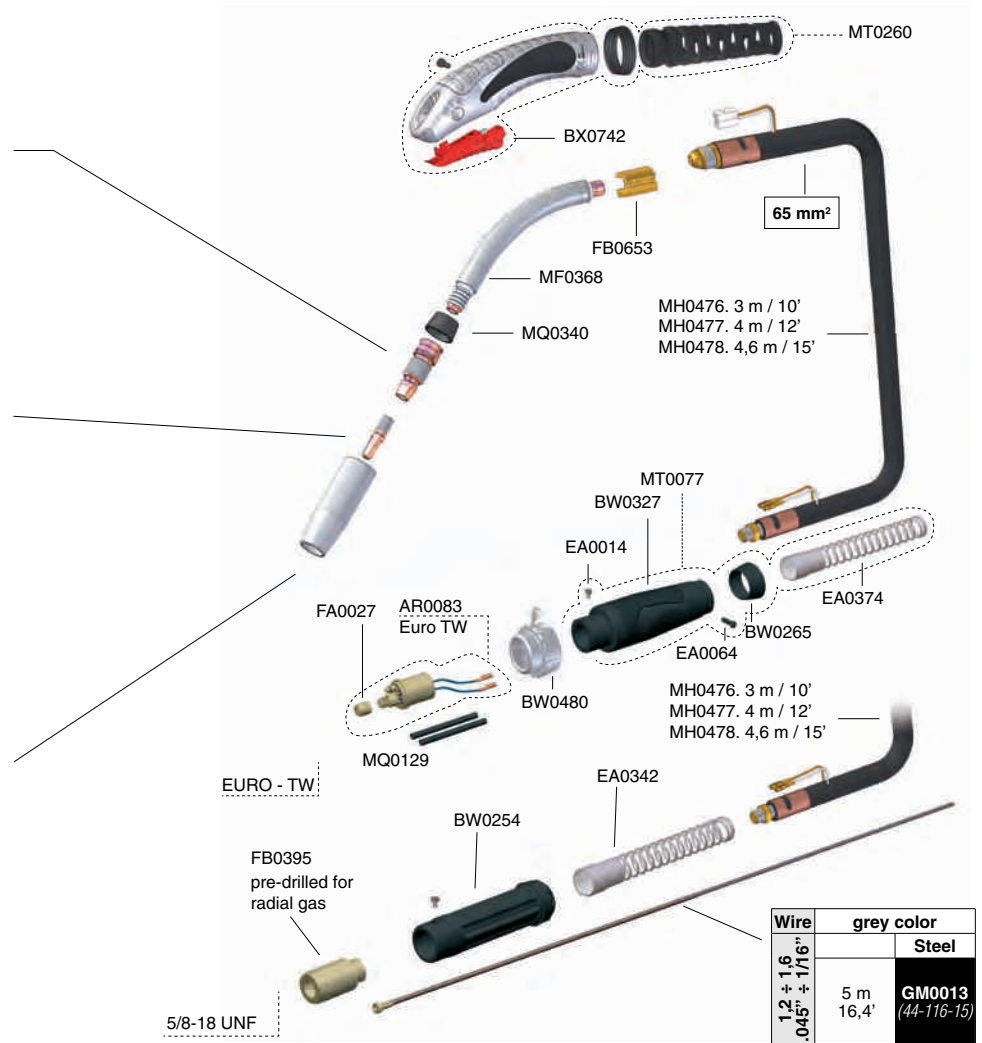

Wire	grey color	
		Steel
1,2 + 1,6 .045" ÷ 1/16"	5 m 16,4'	GM0013 (44-116-15)